

Modular Rubber Screen Application Information

End User: _____ Date: _____

Location: _____ Dealer: _____

Dealer Contact: _____

Equipment

Screening Equipment Manufacturer: _____ Incline or Horizontal: _____

Screen Surface Angle: _____ Deck Size: _____ X _____ Number of Decks _____

Type of Screens in Use: *Rubber* *Wire* *Punch Plate* *Urethane*

What is the wear life? *in tons*: _____

Material

Tons per Hour to Deck: _____ Type of Material: _____

Size (Min. & Max.): _____ Shape of Material: _____

% of Moisture content: _____ % of fines: _____

Is there pegging? Yes No Is there blinding? Yes No

Any additional information including pros and cons of existing system:

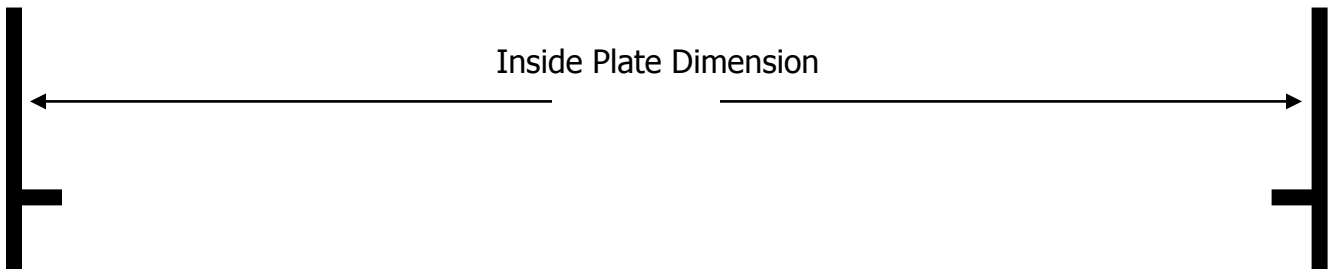

Further notations requested on page two for existing **Synthetic Media Only.**

Current Screen Information

A. Build Height _____

B. Aperture Size _____
 Round Square Slotted

C. Min. Web Width _____

D. Total number of apertures down _____ across _____

E. Web Depth _____

F. Panel Size _____
Length X Width

G. Style _____
Choose Below

H. Features _____
Dams, Diverters, Skid Bars

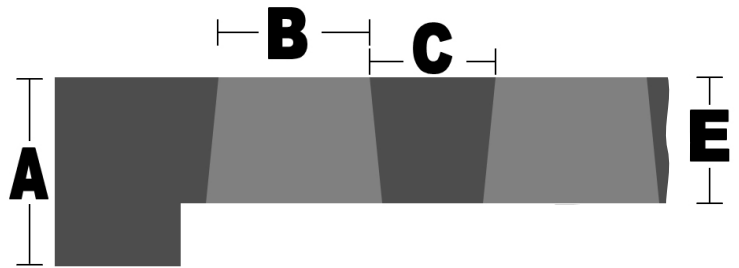

Current Screen Style

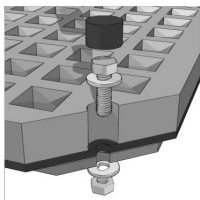

Bolt Down

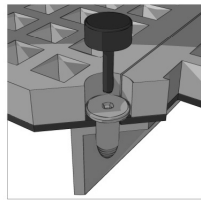

Pin & Sleeve

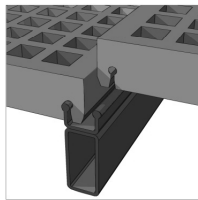

Snap On

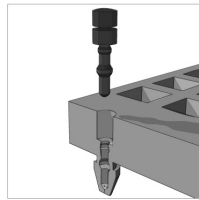

Pin & Leg

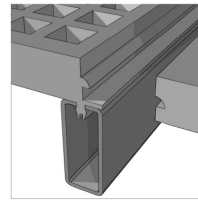

Interlocking